

# THANKS FOR BEING A **RECYCLING MVP**

Join us as we celebrate all the amazing things Team BC has achieved over the past 10 years through our recycling efforts!



Learn more at [RecycleBC.ca](https://RecycleBC.ca)

Flip to visit the **Recycle BC Hall of Fame.**

## RECYCLING COLLECTION SCHEDULE

July 2024 - June 2025

Place paper, containers and glass recycling at curb by:



8:00 am

JULY 2024						
SUN	MON	TUE	WED	THU	FRI	SAT
	1	2	3	4	5	6
7	8	9	10	11	12	13
14	15	16	17	18	19	20
21	22	23	24	25	26	27
28	29	30	31			

AUGUST 2024						
SUN	MON	TUE	WED	THU	FRI	SAT
					1	2
3	4	5	6	7	8	9
10	11	12	13	14	15	16
17	18	19	20	21	22	23
24	25	26	27	28	29	30
31						

SEPTEMBER 2024						
SUN	MON	TUE	WED	THU	FRI	SAT
1	2	3	4	5	6	7
8	9	10	11	12	13	14
15	16	17	18	19	20	21
22	23	24	25	26	27	28
29	30					

OCTOBER 2024						
SUN	MON	TUE	WED	THU	FRI	SAT
			1	2	3	4
5	6	7	8	9	10	11
12	13	14	15	16	17	18
19	20	21	22	23	24	25
26	27	28	29	30	31	

NOVEMBER 2024						
SUN	MON	TUE	WED	THU	FRI	SAT
					1	2
3	4	5	6	7	8	9
10	11	12	13	14	15	16
17	18	19	20	21	22	23
24	25	26	27	28	29	30

DECEMBER 2024						
SUN	MON	TUE	WED	THU	FRI	SAT
1	2	3	4	5	6	7
8	9	10	11	12	13	14
15	16	17	18	19	20	21
22	23	24	25	26	27	28
29	30	31				

JANUARY 2025						
SUN	MON	TUE	WED	THU	FRI	SAT
			1	2	3	4
5	6	7	8	9	10	11
12	13	14	15	16	17	18
19	20	21	22	23	24	25
26	27	28	29	30	31	

FEBRUARY 2025						
SUN	MON	TUE	WED	THU	FRI	SAT
						1
2	3	4	5	6	7	8
9	10	11	12	13	14	15
16	17	18	19	20	21	22
23	24	25	26	27	28	

MARCH 2025						
SUN	MON	TUE	WED	THU	FRI	SAT
						1
2	3	4	5	6	7	8
9	10	11	12	13	14	15
16	17	18	19	20	21	22
23	24	25	26	27	28	29

APRIL 2025						
SUN	MON	TUE	WED	THU	FRI	SAT
			1	2	3	4
5	6	7	8	9	10	11
12	13	14	15	16	17	18
19	20	21	22	23	24	25
26	27	28	29	30		

MAY 2025						
SUN	MON	TUE	WED	THU	FRI	SAT
					1	2
3	4	5	6	7	8	9
10	11	12	13	14	15	16
17	18	19	20	21	22	23
24	25	26	27	28	29	30
31						

JUNE 2025						
SUN	MON	TUE	WED	THU	FRI	SAT
1	2	3	4	5	6	7
8	9	10	11	12	13	14
15	16	17	18	19	20	21
22	23	24	25	26	27	28
29	30					

## COLLECTION MAP

- MONDAY**  
Raspberry, Robson
- TUESDAY**  
Fairview, Pass Creek, West Castlegar
- WEDNESDAY**  
Lower Ootischenia, South Ootischenia, Arrow Lakes Rd., Lakeview Rd.
- THURSDAY**  
Brilliant, North Ootischenia, Sahlstrom Rd.
- FRIDAY**  
Thrums, Shoreacres, South Slochan

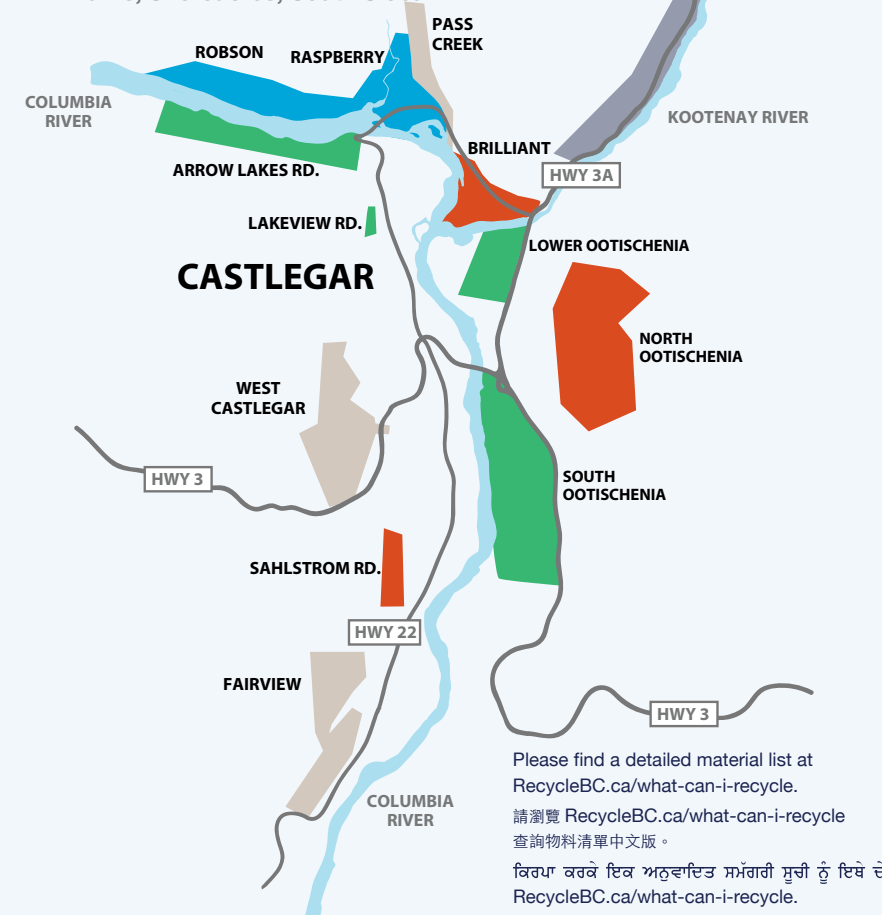

Please find a detailed material list at [RecycleBC.ca/what-can-i-recycle](https://RecycleBC.ca/what-can-i-recycle).  
 請瀏覽 [RecycleBC.ca/what-can-i-recycle](https://RecycleBC.ca/what-can-i-recycle)  
 查詢物料清單中文版。  
 विवरण ढरवें दिख अडुव्वादिउ सभरगरी सूची कू दिखें चंखें  
[RecycleBC.ca/what-can-i-recycle](https://RecycleBC.ca/what-can-i-recycle)  
 번역 된 자료 목록은 [RecycleBC.ca/what-can-i-recycle](https://RecycleBC.ca/what-can-i-recycle)  
 에서 찾으십시오.  
 لطفاً فهرست مواد را به تفصیل در  
[RecycleBC.ca/what-can-i-recycle](https://RecycleBC.ca/what-can-i-recycle) مشاهده کنید.

## ENSURE MORE MATERIALS ARE RECYCLED AND KEPT OUT OF LANDFILL BY REMEMBERING THESE PRO-TIPS:

- Line it up.** Put your cardboard between your boxes, not on top. Leave about 1m (3 feet) of space between recycling boxes and your garbage/organic bins.
- Keep it clean.** Empty and rinse containers to prevent contamination, recycle more materials, and avoid attracting wildlife when you put them out for collection.
- Flatten and cut.** If your cardboard is too big for the blue box, flatten and cut it into smaller pieces, no larger than 76 cm x 76 cm (30 in x 30 in). Stack them loosely between your boxes. Don't forget to keep plastic wrap out of your recycling!
- Avoid litter.** Don't overfill your recycling boxes. If you can't fit everything comfortably, contact Recycle BC's collection partner for an additional box or use a similar open box (like a laundry basket or storage box) to sort your material properly.
- We're here to help.** Download our app, email us at [info@recyclebc.ca](mailto:info@recyclebc.ca) or reach out on social media @RecycleBC.



## OOPS! Did you receive an Oops tag on collection day?

Our collection partners may leave these behind if your material is unable to be collected. The tag will indicate the issue.  
 GFL Environmental is Recycle BC's curbside collection partner in the Regional District of Central Kootenay. They can answer questions about collection zones, missed pick-ups, holiday schedules, or recycling containers.  
**Contact: GFL Environmental**  
 Phone: 1-866-596-5444  
 Email: [csrtrail@gflenv.com](mailto:csrtrail@gflenv.com)

## NEARBY DEPOTS

- Trail Bottle Depot**  
562 Rossland Ave, Trail  
250-364-3025
- Mckelvey Creek Landfill**  
1900 BC-3B, Trail  
250-368-9148
- Ootischenia Landfill**  
670 Columbia Rd, Castlegar  
250-352-8161
- Slochan Transfer Station**  
8875 Slochan South Road, Slochan  
250-352-8161

## ABOUT RECYCLE BC

Recycle BC is a not-for-profit organization responsible for residential packaging and paper product recycling throughout BC, servicing over 2 million households. Recycle BC ensures your household materials are picked up, sorted, and responsibly managed and recycled. Our program is funded by 1,200 businesses that include retailers, manufacturers and restaurants that supply packaging and paper to BC residents, shifting costs away from homeowners.

For more information visit:  
[RecycleBC.ca](https://RecycleBC.ca)  
 @RecycleBC



## DOWNLOAD THE APP

SIGN UP FOR  
 RECYCLING REMINDERS  
 SEARCH THE  
 MATERIAL LIST



# RECYCLEBC

Making a difference together.

## 2024-2025 RECYCLING SCHEDULE

### Central Kootenay



[RecycleBC.ca/](https://RecycleBC.ca/)  
 District-of-Central-Kootenay



# PAPER

PUT INTO ONE BLUE BOX

Cut excess cardboard to 76 cm x 76 cm (30 in x 30 in) and stack beside box  
Clean and dry paper only



# CONTAINERS

PUT INTO ONE BLUE BOX

Empty and rinse containers



# GLASS

PUT INTO GREY BOX

Empty and rinse glass bottles and jars



# DROP-OFF ONLY

TAKE TO RECYCLING DEPOT

Not accepted in your blue boxes or grey box



# 10-YEAR ANNIVERSARY HALL OF FAME

**1.98M TONNES** collected from 2014 - 2023.

That's the weight of 8.6M adult male grizzly bears!

**99%**

of BC has access to recycling.

That's over 2M households with packaging and paper recycling service.

**227 DEPOTS** & 53 London Drugs locations accept flexible plastics.

A decade ago, these materials may have ended up in a landfill.

**\$1 BILLION** contributed by producers since 2014.

This funds the program and shifts costs away from taxpayers and municipalities.

**98%**

of plastics we collect are sent to recycling end markets.

Now, that's something to celebrate!

**73%**

of materials are processed in North America.

Best of all, 99% of plastics stay in BC for recycling.

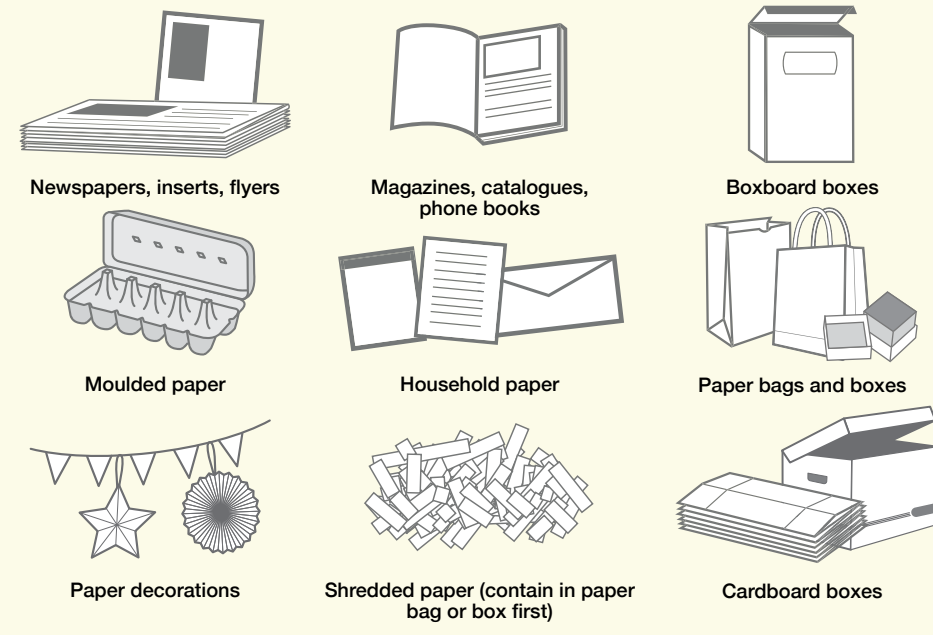

- ✓ Greeting cards
- ✓ Paper gift wrap
- ✓ Paper gift bags
- ✓ Paper carry-out beverage trays
- ✓ Cores from paper towel and toilet tissue
- ✓ Compressed paper hangers
- ✓ Paper-only shipping envelopes



- ✓ Plastic packaging for toys, batteries, etc. Separate plastic from paper backing
- ✓ Plastic pails less than 25L for laundry detergent, cat litter, etc.
- ✓ Spiral wound cans and lids for frozen juice concentrate, chips, etc.
- ✓ Plastic tubs for yogurt, margarine, etc.

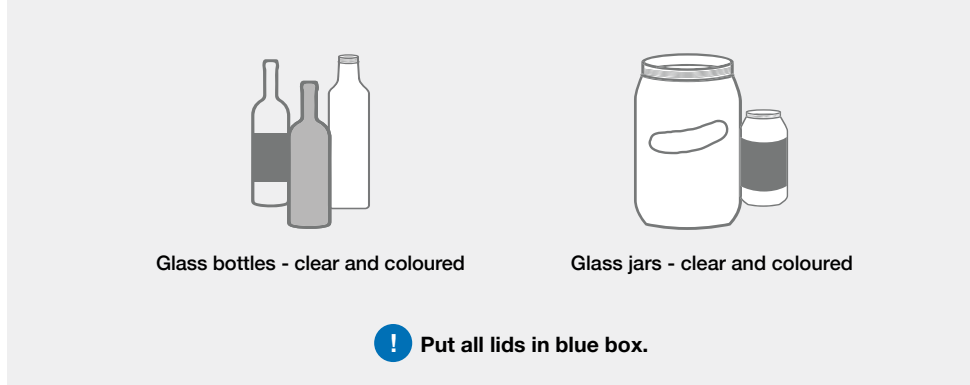

Put all lids in blue box.

## NOT ACCEPTED

- \* Drinking glasses, dishes, or cookware
- \* Window glass or mirrors
- \* Ceramic products
- \* Light bulbs or light fixtures

## Want to recycle something not included here?

Search Recycle BC's Waste Wizard or download a full material list at [RecycleBC.ca](https://www.recyclebc.ca).  
To recycle items that are not packaging, packaging-like products, single-use items, or paper, contact the Recycling Council of BC (RCBC) at [RCBC.ca](https://www.rcbc.ca).

## Unused Medication

Empty medication containers can be recycled with Recycle BC, but unused or expired medications can be safely disposed of by returning them to community pharmacies. For more information or to find the nearest pharmacy, please visit [www.healthsteward.ca](https://www.healthsteward.ca).

## NO HAZARDOUS MATERIALS

Exclude batteries; medical sharps; bleach or aerosol containers with any contents remaining; containers with the words COMBUSTIBLE, FLAMMABLE or VERY FLAMMABLE on them (except cosmetic and beauty product containers); compressed gas cylinders, for example used propane cylinders; containers for paint, motor oil, vehicle lubricants, or antifreeze; or containers for pesticides labelled POISON, and precautionary octagon or diamond symbols with skull and cross bones.

## FLEXIBLE PLASTICS



- ✓ Bags for groceries, produce, and newspapers
- ✓ Overwrap for diapers, feminine hygiene products, paper towels, and soft drink flats

## FOAM PACKAGING

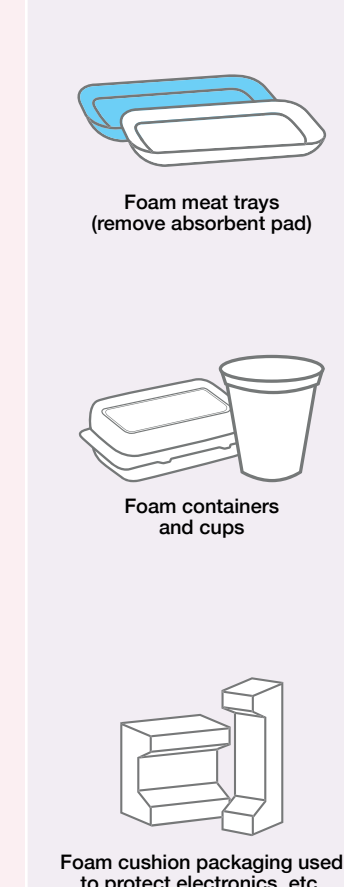

Foam cushion packaging used to protect electronics, etc.

## NOT ACCEPTED



- \* Non-paper gift wrap, foil wrap, cards or paper with glitter
- \* Rubber bands, ribbons, and bows
- \* Paper envelopes with plastic lining
- \* Bubble wrap lined paper envelopes, plastic padded envelopes, etc.
- \* Bags and boxes with foil liners
- \* Paper towels, napkins and tissues
- \* Foil or plastic lined paper bags

## NOT ACCEPTED



- \* Foam packaging
- \* Chip bags and candy wrappers
- \* Stand-up pouches
- \* Packaging labeled biodegradable or compostable
- \* Wiring, metal cords, and hardware
- \* Clothing, textiles and shoes
- \* Food and yard waste

Way to bring your A-game at the bin, BC! Let's work together to make the next 10 years even better.